

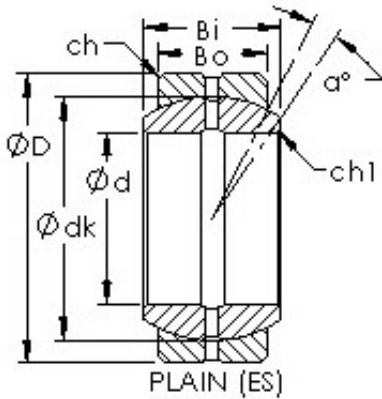

LAD Bearing International Trade Co., ...



AST GEF80ES plain bearings

Bearing No. GEF80ES

Bore Diameter	80 mm
Outer Diameter	130 mm
Bearing Type - plain-wide	plainwide
Bore Dia (d)	80.0000
Outer Dia (D)	130.0000
Outer Width (Bo)	60.0000
Inner Width (Bi)	70.0000
Dynamic Load Rating (Cr)	610,000
Static Load Rating (Cor)	3,060,000
Max. shaft corner radius, or 45 deg. chamfer (ch1)	1.000
Max. housing corner radius, or 45 deg. chamfer (ch)	1.000
Spherical Diameter (dk or Dk)	120.000
Mis-alignment Angle (a deg.)	5
Weight (g)	4,040.00
Material	52100 Chrome steel, or equivalent

GEF80ES Bearing 2D drawings and 3D CAD models