

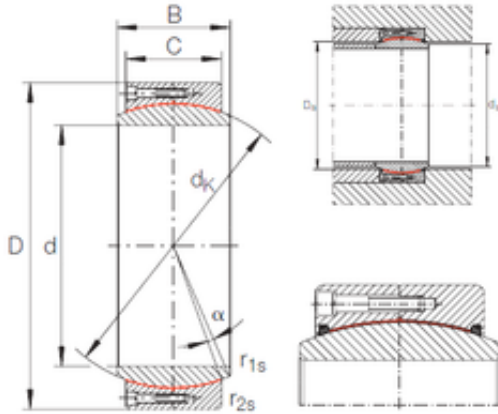

INA GE 950 DW plain bearings



Bearing No. GE 950 DW

Size	950x1250x400 mm
Bore Diameter	950 mm
Outer Diameter	1250 mm
Width	400 mm
d	950 mm
D	1250 mm
B	400 mm
C	340 mm
dk	1100 mm
r1 min.	4 mm
r2 min.	7,5 mm
da max	1024,6 mm
Da min	1052 mm
Angle	3,3 °
Weight	1431 Kg
Basic dynamic load rating (C)	112,2 kN

GE 950 DW Bearing 2D drawings and 3D CAD models