

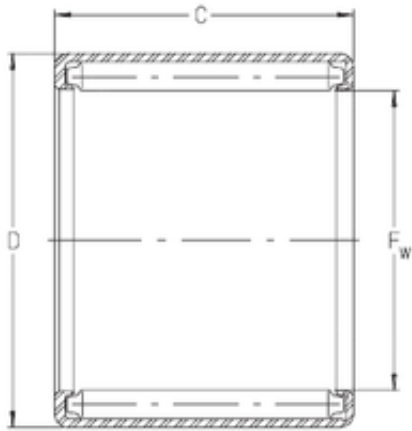

# LAD Bearing International Trade Co., ...



## INA S1710 needle roller bearings

Bearing No. S1710

|                               |                         |
|-------------------------------|-------------------------|
| Size                          | 26.988x33.338x15.875 mm |
| Bore Diameter                 | 26,988 mm               |
| Outer Diameter                | 33,338 mm               |
| Width                         | 15,875 mm               |
| Fw                            | 26,988 mm               |
| D                             | 33,338 mm               |
| C                             | 15,875 mm               |
| Weight                        | 0,028 Kg                |
| Basic dynamic load rating (C) | 21,1 kN                 |
| Basic static load rating (C0) | 44 kN                   |

S1710 Bearing 2D drawings and 3D CAD models