

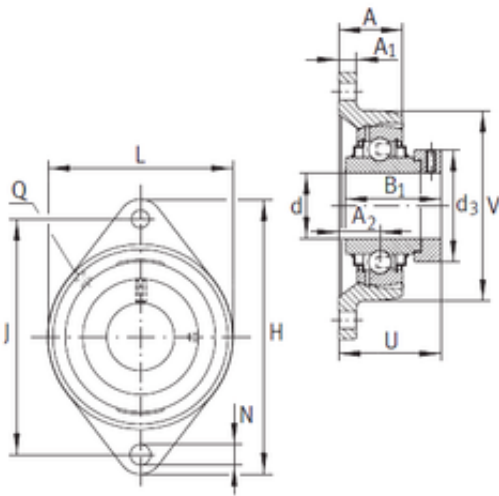

INA LCJT20-N bearing units



LCJT20-N Bearing 2D drawings and 3D CAD models

Bearing No. LCJT20-N

Bore Diameter	20 mm
d	20 mm
V	61 mm
U	45,6 mm
Thread (Q)	Rp1/8
d3	33 mm
A	28 mm
A1	10 mm
B1	43,7 mm
H	112 mm
J	90 mm
L	61 mm
N	11,5 mm
A2	19 mm
Weight	0,52 Kg
Basic dynamic load rating (C)	12,8 kN
Category	Flange Block Bearings
Inventory	0.0
Manufacturer Name	SCHAEFFLER GROUP
Minimum Buy Quantity	N/A
Weight / Kilogram	0.623
EAN	4012802798050
Product Group	B00234
Number of Mounting Holes	2
Mounting Method	Eccentric Collar
Housing Style	2 Bolt Flange Block



## LAD Bearing International Trade Co., ...

Rolling Element	Ball Bearing
Housing Material	Cast Iron
Expansion / Non-expansion	Non-expansion
Mounting Bolts	11.5 Millimeter
Relubricatable	Yes
Insert Part Number	GE20-KLLHB
Seals	Double Labyrinth
Housing Configuration	1 Piece Solid
Pilot Configuration	No Pilot
Inch - Metric	Metric
Long Description	2 Bolt Flange Block; 20MM Bore; 90MM Bolt Circle; 90MM Bolt Spacing; 1 Piece Solid; Eccentric Collar Mount; Cast Iron; Ball Bearing; 43.7MM Length Thru Bore; Relubricatable; Double Labyrinth Seal
Other Features	Single Row   Radial   Metric   With Set Screw
Category	Flange Block
UNSPSC	31171501
Harmonized Tariff Code	8483.20.40.40
Noun	Bearing
Keyword String	Flanged
Manufacturer URL	<a href="http://www.ina.com">http://www.ina.com</a>
Manufacturer Item Number	LCJT20
Weight / LBS	1.103
Bolt Spacing	3.543 Inch   90 Millimeter
Length Thru Bore	1.72 Inch   43.7 Millimeter
Bore	0.787 Inch   20 Millimeter
Cartridge Pilot Diameter	0 Inch   0 Millimeter
Nominal Bolt Circle Diameter Round	3.5 Inch   90 Millimeter